

125mm Stud Mount Number

7125

Contents

Your package should contain the following parts:

1 x Number / Letter

3 x Threaded Pins

3 x Spacers

3 x Wall Plugs

3 x Screws

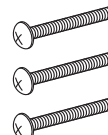
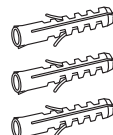
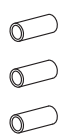
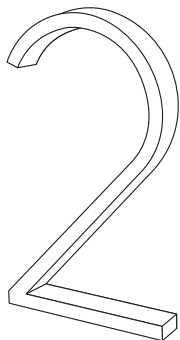

Timber Fence Installation

Ideal for 25 - 30mm fence thickness

Tools Required

- Drill + Timber Drill Bit
- Pencil

1. Screw the threaded pins into the rear of the number.
Position the number / letter in place, and using the pins as a guide, mark the position of the drill holes.

Unscrew the threaded pins from the number / letter.

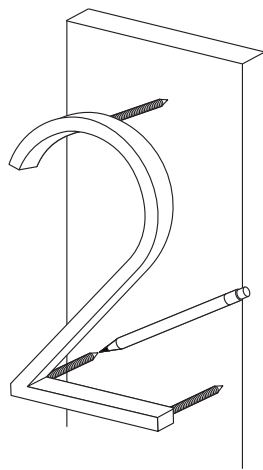

2. In the marked locations, drill 4mm holes through the fence.

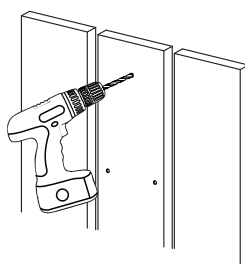

3. Insert the screws into the holes via the rear of the fence. Place the spacers over the ends of the screws, then proceed to screw each of the screws into the rear of the number / letter.

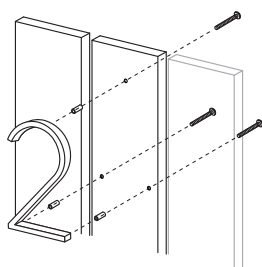

Brick Installation

Tools Required

- Drill / Hammer Drill (ideal)
- Timber or Masonry Drill Bit
- Pencil

1. Screw the threaded pins into the rear of the number.
Position the number / letter in place, and using the pins as a guide, mark the position of the drill holes.

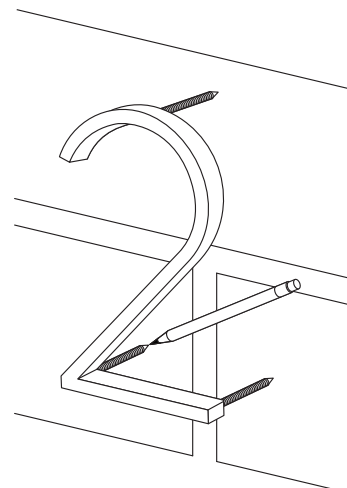

2. In the marked locations, drill 6mm holes into the brick wall.

Insert the wall plugs into the drilled holes.

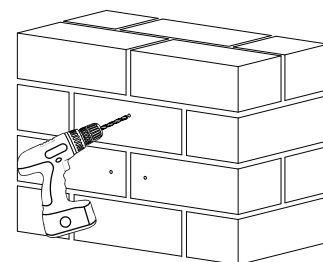

3. Place the spacers over the threaded pins.

Push the number / letter into the wall until the spacers are firmly in place.

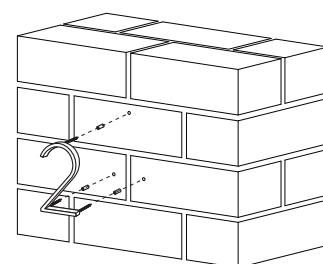

For a fence thickness that is less than 25mm

At step 3, add washers* to the screws prior to inserting into the fence.

*not supplied

Handy Hint

If force is required to push the number / letter into the wall, cover it with a cloth and gently tap it with a rubber mallet.