

Square Vertical Garden

Congratulations on selecting your new artificial vertical garden from Milkcan Outdoor Products.

Welcome to our easy installation guide. The best part is that your vertical garden does not require structural work before installation (since the panels are very light).

The installation method will be slightly different depending on your chosen mounting surface. Please ensure you use the correct method to achieve the best outcome for long lasting green walls.

Installation

1. Remove the green wall panels from their boxes.
2. Identify the correct direction of the foliage to ensure a realistic look.
3. Follow the relevant installation instructions below (according to your chosen mounting surface).

People required:
1 to 2 people
Installation time:
Approx. 5 mins per panel



Timber / Plaster

Tools required:

- Staple Gun + Staples
- Drill + Screws (try using screws with a large head for more coverage)

1. Place the first panel against the top left corner of your fence/wall and attach using the staples or screws. For screws, use the circular holes on the back of the panel. We typically recommend 8-12 attachment points per panel.
2. See 'Assembling your wall' instructions (see next page) on how to assemble the rest of your green wall. Secure each panel by repeating the step above.

Tip: Pull apart the leaves when stapling to ensure you only attach the backing grid of the panel to the mounting surface. This will mean your panel looks more full and you don't see the staples or screws.

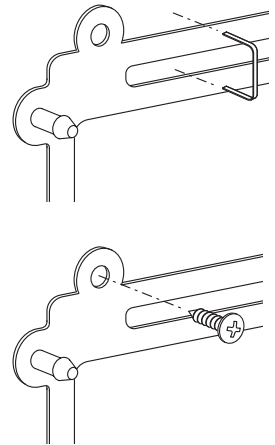

Colorbond Fencing

Tools required

- Staple Gun + Staples
- Drill + Screws (try using screws with a large head for more coverage)
- Timber Battens or Fence Palings

Option 1 Screwing the panels into timber battens/palings

1. Screw vertical timber battens/palings (about 30cm apart) to the capping at the top and bottom of the fencing.
2. Secure your panels by following the 'timber / plaster' installation instructions.

Option 2 Screwing the panels directly into fence capping

1. Attach the first panel to the top left corner of the fence, screwing through the capping along the top of the fence at 25cm intervals.
2. Proceed to join the next panel to the right side of the first one using the panels hole and lug system. Repeat step one until the full length of the fence is covered.
3. Once you have attached the panels along the full length of the fence, simply join the next row of panels and repeat until you get to the bottom row of panels. Secure the bottom row to the base of the fence by screwing or cable tying them.

Note: Both of these options will ensure that screws do not protrude on the other side of the fence.

Option 1

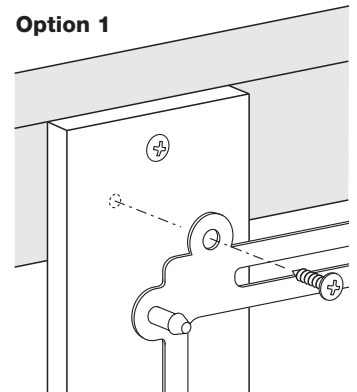

Option 2

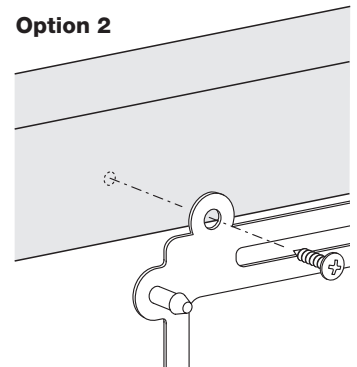

Concrete / Brick / Stone / Render

Tools required:

- Hammer Drill + Masonry Drill Bit
- Screws (try using screws with a large head for more coverage)
- Wall Plugs
- Hammer
- Pencil

1. Place your first panel against the top left corner of your fence/wall and mark the drill location in the top left corner hole. Drill the marked hole using the hammer drill with masonry bit.
2. Lightly hammer a wall plug into the drilled hole and secure with a screw.
3. Align the panel correctly and use it as a guide to mark all the other drill locations. Drill the marked holes and repeat step 2.
4. See 'Assembling your wall' instructions (see next page) on how to assemble the rest of your green wall. Secure each panel by repeating the steps above.

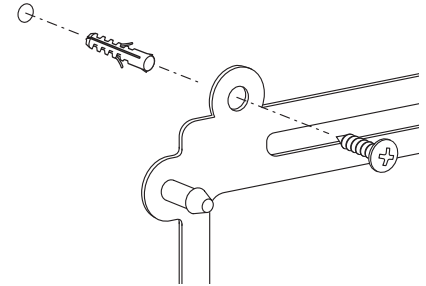

Tip: We would recommend adding more attachment points (equally spaced) if the area is exposed to wind.

Wire / Cyclone / Mesh Fencing

Tools required:

- Black Cable Ties

1. Place your first panel against the top left corner of your fence and using cable ties, simply pass them through the fence and pull tight.
2. Repeat the process every 25cm across the top, sides and bottom edges. If needed, add more cable ties to the centre of the panel to ensure it sits flat.
3. See 'Assembling your wall' instructions (see next page) on how to assemble the rest of your green wall. Secure each panel by repeating the steps above.

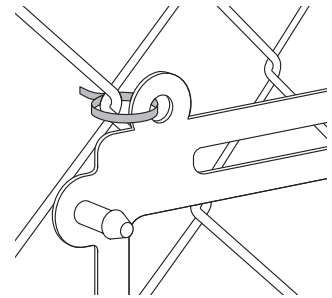

Tip: We would recommend adding more attachment points (equally spaced) if the area is exposed to wind.

Assembling your wall

1. Attach your first panel to the top left corner of your chosen mounting surface (as previously instructed).
2. Place the second panel to the right side of the first panel. Lock the two panels together using the clips along the left side. Use a spirit level to ensure the wall garden is level.
3. Secure each panel as specified in the installation instructions.
4. Repeat this process until the top row is complete. Once the top row is locked and secured in place move down to the next row.
5. Repeat above steps until all panels have been clipped in place and secured.

Tip: If needed, use garden clippers to trim any excess overhang along any of the sides.

