

# Adhesive House Number

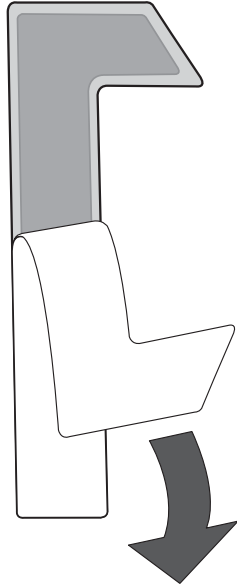

## Step 1

Peel off protective backing.

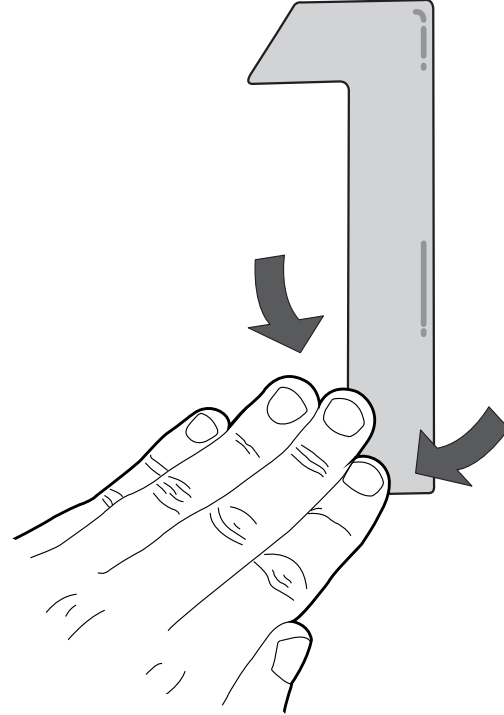

## Step 2

Ensure surface is clean and dry.  
Carefully choose the position for the  
number and press it down firmly.

## Handy Hint

Lightly pre-mark the correct position for the number(s) with a pencil.  
Once the number(s) are in place remove any pencil marks with a damp rag.