

# VALENCIA LETTERBOX

## Installation Instruction Sheet

Congratulations on purchasing the Valencia letterbox. We have designed the Valencia to offer a stylish, efficient and convenient way to receive mail and newspapers. It also receives large A4 envelopes and offers excellent security for your mail. The rear door with keylock offers an easy and convenient means of retrieving your mail.

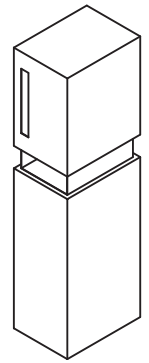

## Installation

The Valencia letterbox receives general mail. You will need to mount it in a location that is easily accessible to Australia Post. This will typically be at your front boundary.

### Mounting onto an existing concrete floor

1. Mark the front edge of the bottom mounting frame so that you know which side is the front when it is removed

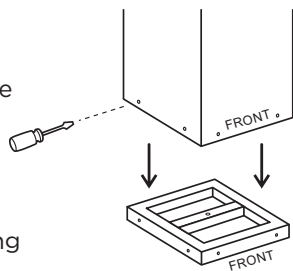

2. Unscrew the mounting frame

3. Place the mounting frame in the chosen location and mark the mounting hole with a pencil

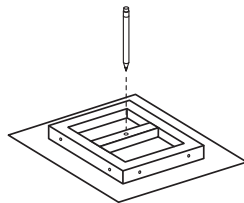

4. Drill a hole (10mm diameter x 60mm deep) into the concrete floor for the mounting bolt

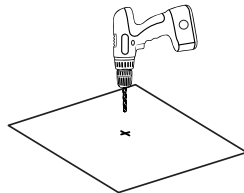

5. Bolt the mounting frame to the concrete floor with the mounting bolt provided

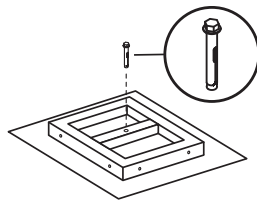

6. Place the Valencia letterbox back over the mounting frame and secure with the screws that were removed in step 2

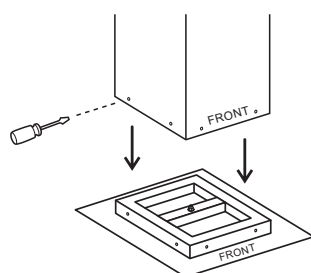

### Mounting onto ground

You will need to install a small concrete slab that is suitable for your letterbox to be bolted onto.

1. Dig a hole approximately 30cm x 35cm x 10cm deep

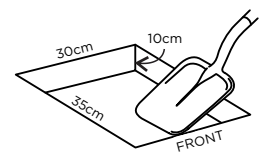

2. Fill hole with concrete. Use a spirit level to level the concrete and then leave it to fully dry

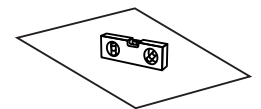

3. Mark the front edge of the bottom mounting frame so that you know which side is the front when it is removed

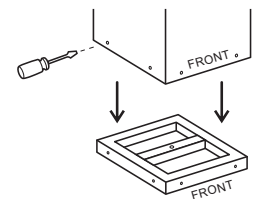

4. Unscrew the mounting frame

5. Place the mounting frame in the chosen location and mark the mounting hole with a pencil

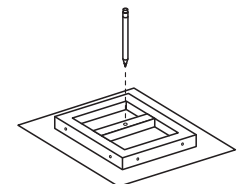

6. Drill a hole (10mm diameter x 60mm deep) into the concrete floor for the mounting bolt

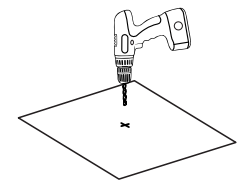

7. Bolt the mounting frame to the concrete floor with the mounting bolt provided

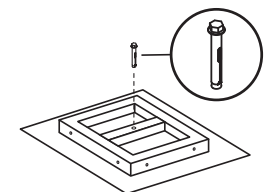

8. Place the Valencia letterbox back over the mounting frame and secure with the screws that were removed in step 4

