

INSTALLATION INSTRUCTIONS

BRICK - PAPER HOLDERS

Please use these instructions as a general guide for the following brick-in paper holder sets:

- 175 Palazzo Rectangle
- 176 Palazzo Square
- 179 Palazzo (CRM)
- BR01 (GRA, LCR)

1. Cut a piece of 100mm PVC pipe to the desired length. Join the front paper holder with the pipe and seal with silicone.

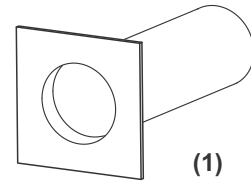

2. Screw in the threaded rods provided

3. Build brickwork up to desired height. Cut bricks down so that the paper holder sits centre.

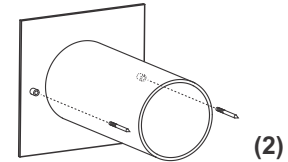

4. Mark bricks where threaded rods will align. Drill two 8mm holes and insert wall plugs. Lay down mortar and push paper holder into brick wall.

5. Join the back paper holder onto the other end of the pipe and repeat step 4.

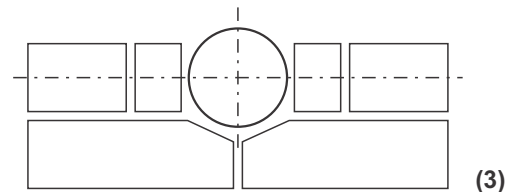

6. Complete remaining brickwork around paper holder set.

